

BLOWDOWN VALVE BDV

DESCRIPTION

The BDV blowdown valve is an optional, designed for steam traps with integral strainer, and protects the trap from contamination through the manual discharge of trap of strainer contents. The device is applied to the following models: DT46, DT42/2, TH32, BM20, BM32, CDV, UCX41 and CTS4U.

USE: Discharge of strainer screen contents.

AVAILABLE

MODELS: BDV-M22; BDV-M28 and BDV-10.

SIZES: M22; M28 and 3/8".

CONNECTIONS: Threaded metric or NPT.

Limiting conditions:

PMA – Max. allowable pressure 63 bar

TMA – Max. allowable temperature 400 °C

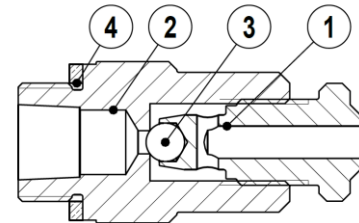
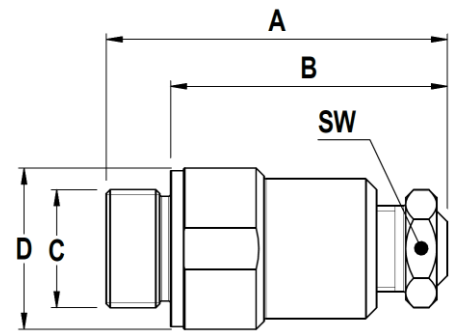

DIMENSIONS (mm)						
MODEL	A	B	C	D	SW	WEIGHT (kg)
BDV-M22	60	51	M22	29	19	0,2
BDV-M28	60	51	M28	29	19	0,27
BDV-10	60	51	3/8"	40	19	0,18

MATERIALS		
POS. N°	DESIGNATION	MATERIAL
1	Screw	AISI 304 / 1.4301
2	Body	AISI 304 / 1.4301
3	Ball valve	AISI 440C / 1.4125
4	Gasket	Stainless steel / Graphite

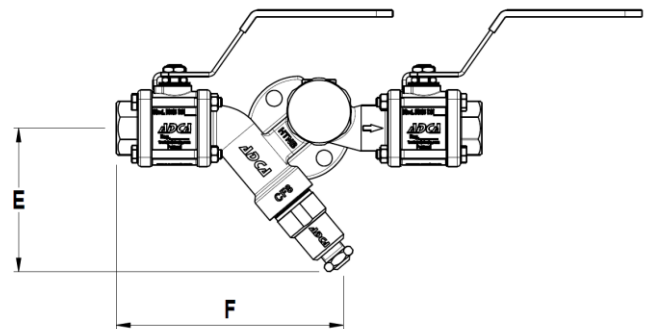
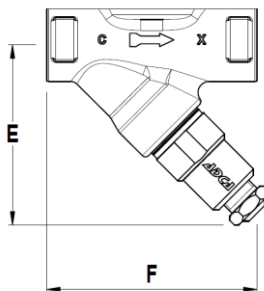

DIMENSIONS WHEN APPLIED TO STEAM TRAPS (mm)																
SIZE	STEAM TRAP MODEL															
	DT46		DT42/2		TH32		BM20		BM32		CDV		UCX41		CTS4U	
	E	F	E	F	E	F	E	F	E	F	E	F	E	F	E	F
1/2" – DN 15	83	94	83	94	83	94	83	94	83	94	83	94	83	102	94	148
3/4" – DN 20	83	94	83	94	83	94	83	94	83	94	83	94	83	102	94	148
1" – DN 25	90	100	90	100	90	100	90	100	90	100	90	100	83	108	–	–