

FLOAT AND THERMOSTATIC STEAM TRAPS FLT32 (Cast steel DN 40 – 50)

DESCRIPTION

The FLT32 float and thermostatic (integral air vent) steam traps series are designed for all types of low and high pressure steam heating and process equipment.

Typical applications include unit heaters, heat exchangers, driers, jacketed vessels and all the applications where continuous drainage is essential.

Connections are female screwed or flanged for horizontal or vertical installation.

MAIN FEATURES

Modulating discharge.

Discharges condensate at steam temperature.

Unaffected by sudden or wide load and pressure changes.

Excellent air discharge (by thermostatic air vent).

OPTIONS: SLR – steam lock release.
Equalizing plug or vent connection.

USE: Saturated and superheated steam.

AVAILABLE

MODELS: FLT32-4,5 , 10 , 14 and 21.

SIZES: 1 1/2" to 2" ; DN 40 to DN 50.

CONNECTIONS: Female screwed ISO7/1 Rp (BS21).
Flanged EN 1092-1 PN40 or ANSI.

INSTALLATION: Standard horizontal installation –
From right to left FLT32 (R-L).

Upon request:

-horizontal installation with the flow from left to right (L-R).

-vertical installation with the flow from top to bottom (V).

MAX. DIFFERENTIAL PRESSURE

FLT32-4,5 : 4,5 bar

FLT32-10 : 10 bar

FLT32-14: 14 bar

FLT32-21: 21 bar

CE MARKING (PED – European Directive)	
PN40	Category
DN 40 to DN 50	1 (CE marked)



BODY LIMITING CONDITIONS		
FLANGED PN40 / ANSI 300 lb **	FLANGED ANSI 150 lb **	RELATED TEMPERATURE
ALLOW. PRESS.	ALLOW. PRESS.	
37,1 bar	15,4 bar	100 °C
33,3 bar	13,8 bar	200 °C
30,4 bar	12,1 bar	250 °C
27,6 bar	10,2 bar	300 °C

PMO – Max. operating pressure 32 bar

TMO – Max. operating temperature 250 °C

*Acc. to EN1092-1:2018 ; **Acc. to EN1759-1:2004

Body limiting conditions PN40 or below, depending on the type of connection adopted. Rating PN40 for thread, SW and BW.

FLOW RATE CAPACITY (kg/h)												
MODEL	SIZE DN	DIFFERENTIAL PRESSURE (bar)										
		0,5	1	1,5	2	4,5	7	10	12	14	16	21
FLT32-4,5	40-50	2400	3400	3900	4500	7300	–	–	–	–	–	–
FLT32-10	40-50	1500	2000	2600	3000	4000	5400	6200	–	–	–	–
FLT32-14	40-50	950	1300	1600	1800	2600	3250	3900	4210	4950	–	–
FLT32-21	40-50	950	1300	1600	1800	2600	3250	3900	4210	4950	5000	5600

DIMENSIONS (mm)

SIZE	Screwed						PN16/40			ANSI 150 lb			ANSI 300 lb		
	A	B	C	D	E	WGT. (kg)	F	B	WGT. (kg)	F	B	WGT. (kg)	F	B	WGT. (kg)
1 1/2" – DN 40	210	248	79	208	131	16,9	230	248	20,3	230	248	19,1	230	248	22,1
2" – DN 50	210	248	79	208	131	17,5	230	248	20,7	230	248	20,5	230	248	22,3

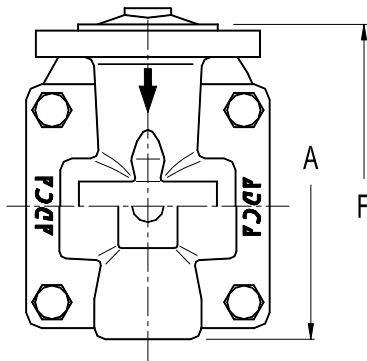
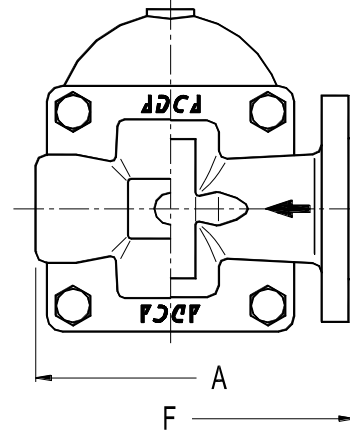
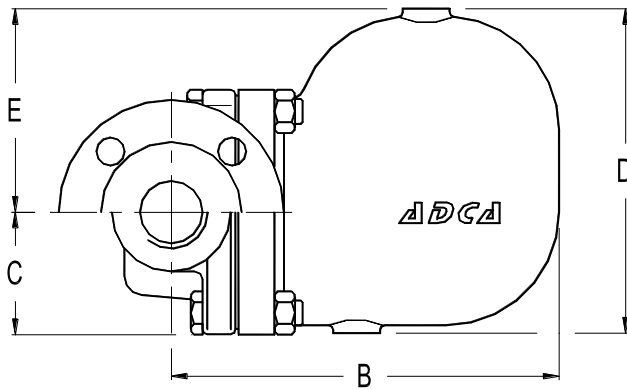

Vertical Installation (V)

MATERIALS

POS. N°	DESIGNATION	MATERIAL
1	Body	GP240GH / 1.0619
2	Cover	GP240GH / 1.0619
3	*Gasket	Stainless steel / Graphite
4	*Seat	CF8 / 1.4308
5	*Valve	AISI 420 / 1.4021
6	*Lever	AISI 304 / 1.4301
7	*Float	AISI 304 / 1.4301
8	*Air vent	Stainless st. (bimetallic)
9	Bolts	Steel 8.8

* Available spare parts.

