

SINGLE WINDOW SIGHT GLASS SW12

DESCRIPTION

For monitoring the right operation of a steam trap, in order to avoid leakages of live steam and, consequently, great energy losses, a sight glass is recommended to be installed downstream of the steam trap.

The single window SW12 sight glasses have been designed for this particular application. Connections are female screwed.

OPTIONS: Mica shield discs.

USE: Condensate pipes, downstream of the steam traps.

AVAILABLE MODELS: SW12 - 5 mm thick glass.

SIZES: 1/2", 3/4" and 1".

CONNECTIONS: Female screwed ISO 7/1 Rp (BS21).

INSTALLATION: Horizontal or vertical installation.
See IMI – Installation and maintenance instructions.



PMO – Max. operating pressure 12 bar
TMO – Max. operating temperature 150 °C
How to order: i.e. SW12 1/2" BSP.

DIMENSIONS (mm)					
SIZE	A	B	C	D	WGT. (kg)
1/2"	80	16	62	52	0,6
3/4"	88	19	62	57	0,9
1"	88	23	62	60	0,85

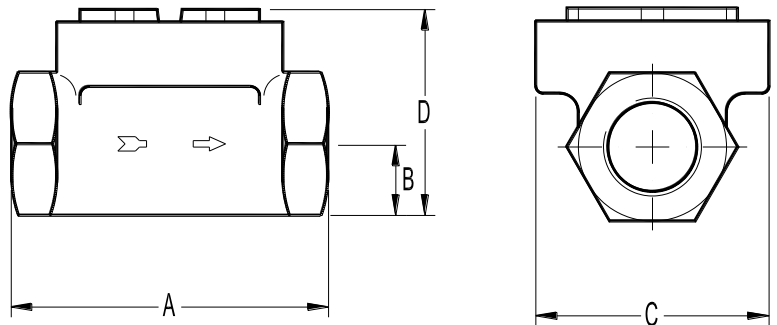

MATERIALS		
POS. Nº	DESIGNATION	MATERIAL
1	Body	Brass EN12165 / CuZn39Pb2
2	Glass nut	Brass EN12165 / CuZn39Pb2
3	* Gasket	Stainless steel / Graphite
4	* Window glass	Tempered borosilicate glass

* Available spare parts.

